

Product Information Gas Detector GW 702

Safety on the whole line

Working with dangerous gases involves fulfilling high safety conditions for the protection of people and the environment. Included in such safety measures is the monitoring of the ambient air with gas warning devices, which register the increased concentration of gases in the shortest of time and release an alarm if the maximum limits are exceeded.

Such gas warning devices are typically used in chlorine gas areas of swimming pools or water works, but also in other installations in industry with ozone and other dangerous gases.

A versatile partner

The GW 702 is Lutz-Jesco's fourth generation of gas warning devices. The progressive development of the semiconductor technology makes for an ever more precise and faster sensor and measurement process.

Its very precise measurement range and the use of high-quality sensors for chlorine gas, chlorine dioxide and ozone guarantee a high quality and durability (2 years). There is the possibility of connecting typical warning signals (horn, flashing lights) and/or the circuitry of emergency systems (e.g. sprinkler systems) and the fact that it is easy to use rounds off the versatility of the GW 702.

Reliable and maintenance-free

The GW 702 consists of a wall casing with up to two external sensors. The most modern components of micro-electronics are used in the GW 702. A processor monitors the 2 sensor inlets and the measured value within the given limit values. The alarms are switched by three relays. An analogue output (0/4...20 mA) can be used to transfer the measured value.

The sensor is automatically electrically examined in a programmable time frame. The sensor test can be carried out manually at any time. The sensors operate without the need of maintenance. The GW 702, depending on the model, is delivered with one or two sensors incl. 10 m of cable and a mounting plate.

In short

- For use with chlorine gas, chlorine dioxide and ozone
- Compact wall casing
- Up to 2 sensors
- Controlled by a microprocessor
- 2 freely adjustable limit values of the alarm
- 3 isolated relay outputs
- 1 analogue output 0/4...20 mA
- Digital display
- Automatic or manual sensor test



Technical data

| | |
|------------------------------|--|
| Scope of application | Chlorine gas, chlorine dioxide or ozone |
| Measuring range | Chlorine gas: 0 ... 10.00 ppm Chlorine dioxide: 0 ... 1.00 ppm Ozone: 0 ... 1.00 ppm |
| Number of sensors | up to 2 |
| Cable length for each sensor | 10 m (configurable) |
| Relay output | Relay 1 for alarm 1 Relay 2 for alarm 2 Relay 3 for alarm 2, immediately acknowledgeable |
| Switch point alarm | 2 |
| Alarm 1 (early warning) | preset at 2.00 ppm, adjustable |
| Alarm 2 (main alarm) | preset at 10.00 ppm, adjustable |
| Analogue output | 1x, 0/4...20 mA, galvanically separated |
| Burden | max. 500 Ohm, resolution < 0.001 mA |
| LCD display | 2 x 16 characters, alpha-numeric, illuminated |
| Voltage supply | 230 V AC, 50/60 Hz |
| Power input | 10 VA |
| Casings | for wall mounting |
| Dimensions (H x W x D) | 160 x 165 x 85 mm |
| Protection class | IP65 |

Product Information Gas Detector GW 702

Model variants

| Product | Number of sensors | Order no. |
|-----------------------------------|-------------------|-----------|
| GW 702 Chlorine gas 0...10 ppm | 1 | 23600250 |
| GW 702 Chlorine gas 0...10 ppm | 2 | 23600251 |
| GW 702 Chlorine dioxide 0...1 ppm | 1 | 23600252 |
| GW 702 Chlorine dioxide 0...1 ppm | 2 | 23600253 |
| GW 702 Ozone 0...1 ppm | 1 | 23600254 |
| GW 702 Ozon 0...1 ppm | 2 | 23600255 |

Dimensional figure

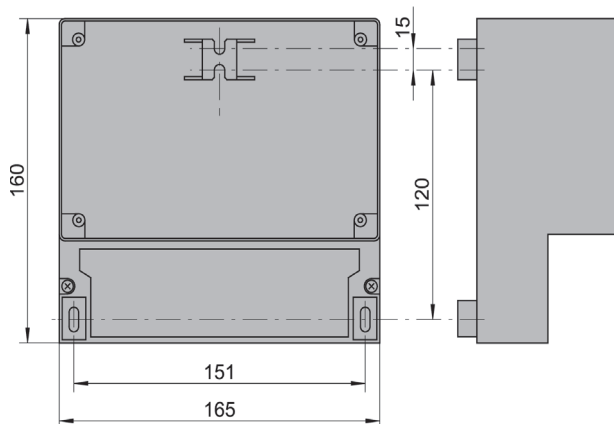

All dimensions in mm

Accessories

| Description | Order no. |
|-------------------------|-----------|
| Sensor bracket | 78657 |
| Chlorine gas sensor | 78658 |
| Chlorine dioxide sensor | 78659 |
| Ozone sensor | 78673 |
| Pipe clamp d 25 PE | 13606 |